

## ITEM OPPORTUNITY SYNOPSIS:

Item to be Scouted

Supplier Scouting Number

NAICS Code, if known

<b>TECHNICAL INFORMATION:</b>	<b>1. Describe the Item:</b>		
		<b>a. Please describe the item application/ the end use of item.</b>	
	<b>2. Summary of Technical Specifications and Performance Requirements:</b>	<b>b. Provide the item number if applicable: (N95 Mask vs Protective Mask).</b>	
		<b>a. Provide dimensions / size / tolerances / performance specifications for the item.</b>	
		<b>b. List required materials needed to make the product, including materials of product components, if applicable.</b>	
		<b>c. Are there applicable certification requirements to supply this item? (i.e. ISO certification) Are there any applicable regulations that apply to the production of this item? (i.e. FDA regulations or EPA regulations) Are there any other standard requirements? (i.e. ASME Standard, IEEE Standard) Please specify.</b>	
		<b>d. Describe the manufacturing processes (elaborate to provide as much detail as possible).</b>	
		<b>e. Additional Comments:</b>	
		<b>Is there other information that would impact the item's performance or usefulness? Please explain.</b>	

<b>BUSINESS INFORMATION:</b>		<b>f. Potential Business Volume Estimate (i.e., # Units Per Day, Month, Year):</b>
		<b>g. Target Price / Unit Cost Information:</b>
	<b>3. Delivery Requirements:</b>	<b>a. When is it needed by? (Immediate, 30 Days, 6 months, etc.)</b>
<b>b. Describe packaging requirements (i.e., individually/ group packaging).</b>		
	<b>c. Where is this opportunity located? Is there a preferred shipping proximity - if applicable?</b>	
<b>4. Additional Comments:</b>	<b>a. Opportunities will be posted for 30 days unless another timeframe is given below</b>	
	_____ days	
	<b>b. Is there other information you would like to include?</b>	

Photos or diagrams of the item (helpful but not required).

# LYNX 640

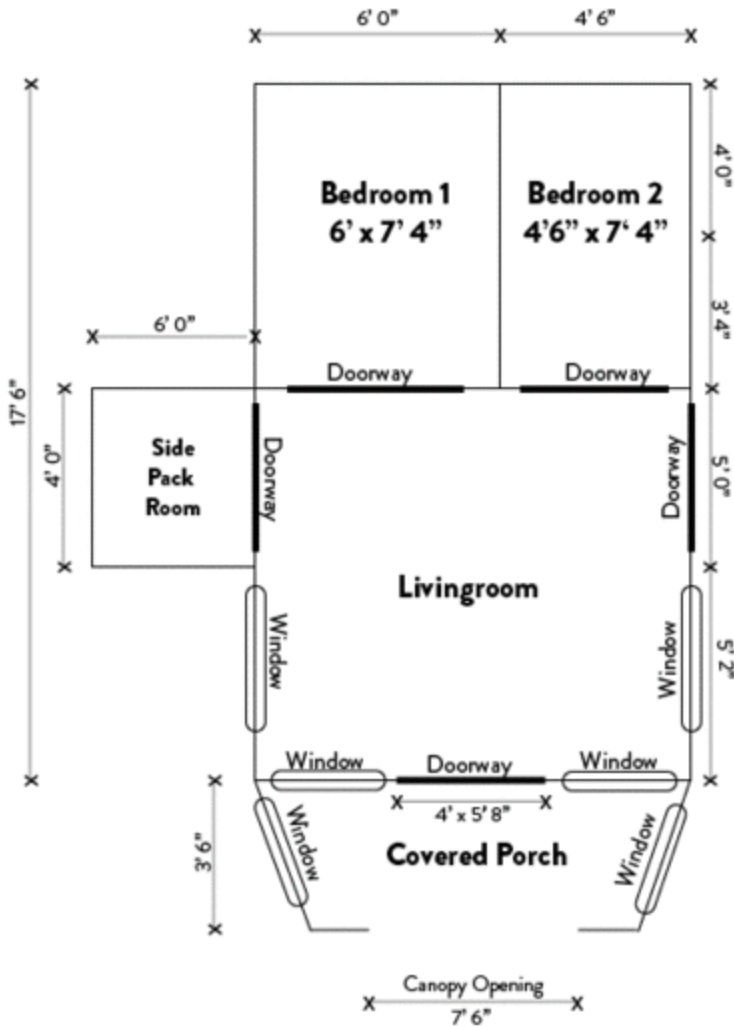

-  **Bedroom Headroom: 6' 4"**
-  **Livingroom Headroom: 6' 11"**
-  **Covered Porch Headroom: 6' 11"**

## FEATURES

- + 228 Sqft Interior
- + 30 Sqft Exterior
- + 6' 11" of Headroom
- + Polycotton Fabric w/ Ripstop: Cotton creates breathability while polyester allows for waterproofing and ripstop
- + Reflective guy lines
- + Guy line storage pockets
- + Queen size bedroom #1
- + Full size bedroom #2
- + Fixed privacy/storage room
- + Doors & windows w/ "no-see-um" grade mesh
- + 4 different bedroom configurations
- + Storage pockets on bedrooms
- + Air truss easy up/easy down system
- + Hand pump included
- + Power supply entry door

# BOBCAT 500 Series

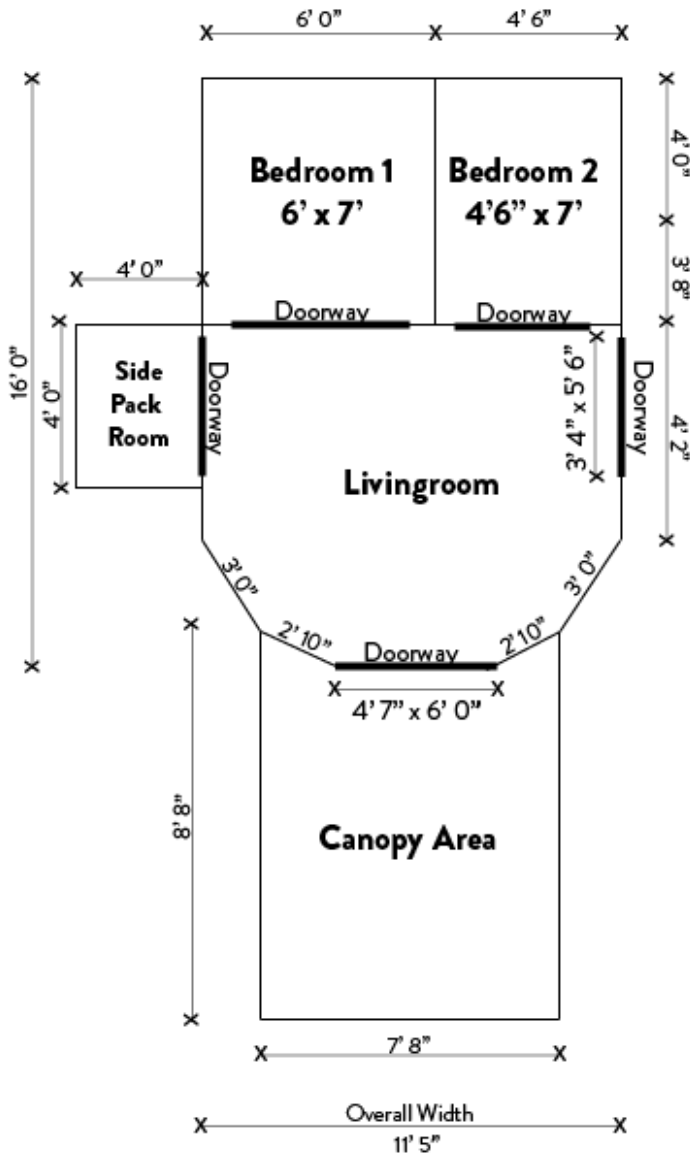

 **Bedroom Headroom: 5' 10"**

 **Livingroom Headroom: 6' 8"**

 **Canopy Headroom: 6' 0"**

## FEATURES

- + 202 Sqft Interior
- + 66 Sqft Exterior
- + 6' 8" of Headroom
- + Polycotton Fabric w/ Ripstop: Cotton creates breathability while polyester allows for waterproofing and ripstop
- + Reflective guy lines
- + Guy line storage pockets
- + Queen size bedroom #1
- + Full size bedroom #2
- + Fixed privacy/storage room
- + Doors & windows w/ "no-see-um" grade mesh
- + 4 different bedroom configurations
- + Storage pockets on bedrooms
- + Air truss easy up/easy down system
- + Hand pump included
- + Power supply entry door

