

ITEM OPPORTUNITY SYNOPSIS:

Item to be Scouted

Supplier Scouting Number

NAICS Code, if known

TECHNICAL INFORMATION:	1. Describe the Item:		
		a. Please describe the item application/ the end use of item.	
	2. Summary of Technical Specifications and Performance Requirements:	b. Provide the item number if applicable: (N95 Mask vs Protective Mask).	
		a. Provide dimensions / size / tolerances / performance specifications for the item.	
		b. List required materials needed to make the product, including materials of product components, if applicable.	
		c. Are there applicable certification requirements to supply this item? (i.e. ISO certification) Are there any applicable regulations that apply to the production of this item? (i.e. FDA regulations or EPA regulations) Are there any other standard requirements? (i.e. ASME Standard, IEEE Standard) Please specify.	
		d. Describe the manufacturing processes (elaborate to provide as much detail as possible).	
		e. Additional Comments:	
		Is there other information that would impact the item's performance or usefulness? Please explain.	

BUSINESS INFORMATION:		f. Potential Business Volume Estimate (i.e., # Units Per Day, Month, Year):
		g. Target Price / Unit Cost Information:
	3. Delivery Requirements:	a. When is it needed by? (Immediate, 30 Days, 6 months, etc.)
b. Describe packaging requirements (i.e., individually/ group packaging).		
	c. Where is this opportunity located? Is there a preferred shipping proximity - if applicable?	
4. Additional Comments:	a. Opportunities will be posted for 30 days unless another timeframe is given below	
	_____ days	
	b. Is there other information you would like to include?	

Photos or diagrams of the item (helpful but not required).

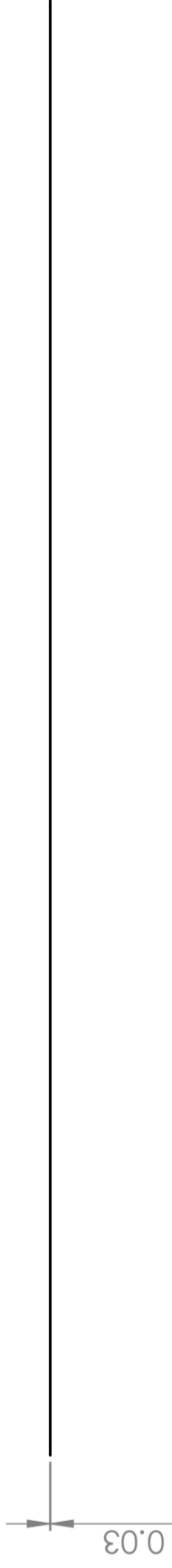
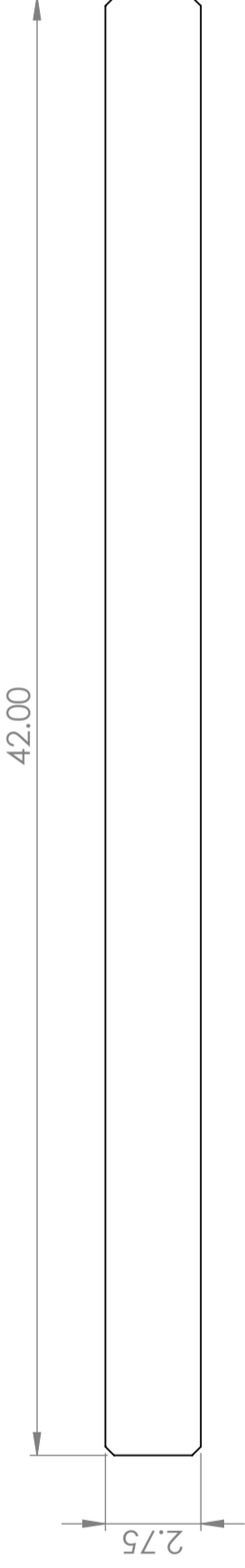
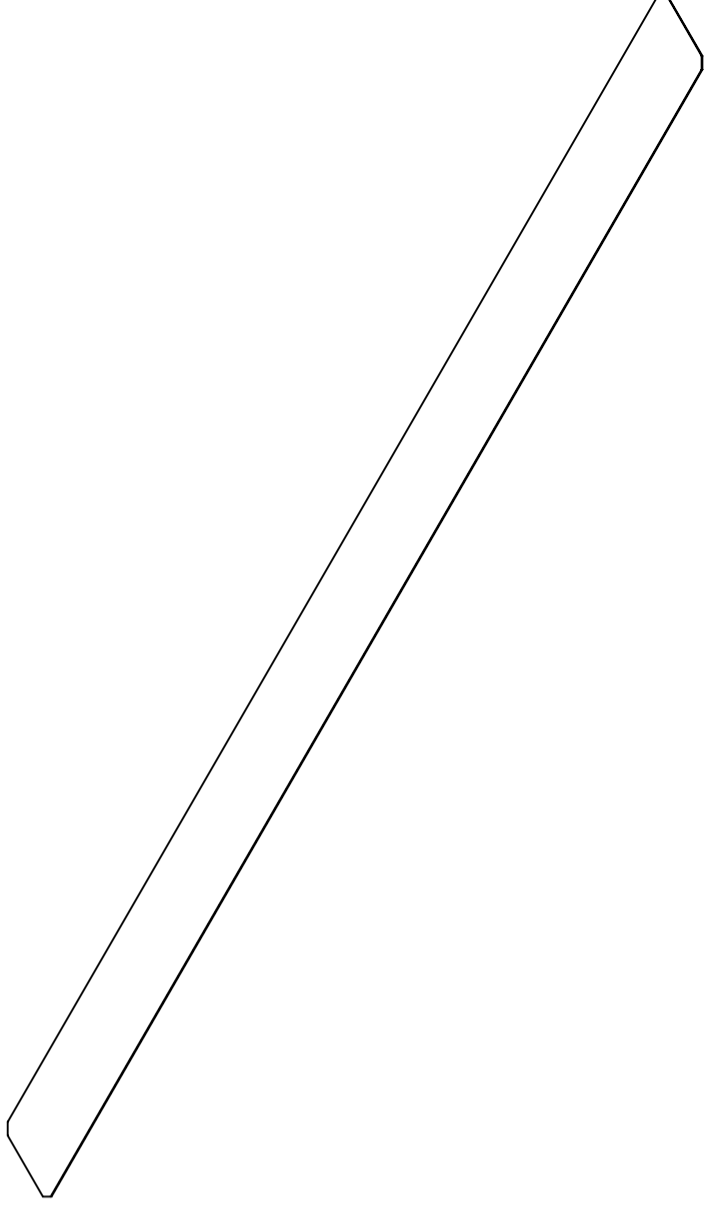

UNLESS OTHERWISE SPECIFIED: DIMENSIONS ARE IN INCHES		FINISH:		DEBUR AND BREAK SHARP EDGES		DO NOT SCALE DRAWING		REVISION	
SURFACE FINISH:									
TOLERANCES:									
LINEAR:									
ANGULAR:									
NAME	SIGNATURE	DATE	TITLE:						
DRAWN									
CHK'D									
APP'VD									
MFG									
Q.A.									
			MATERIAL:		DWG NO. Rev2_Belt_Core				
					A3				
					SCALE: 1:5				
					SHEET 1 OF 1				

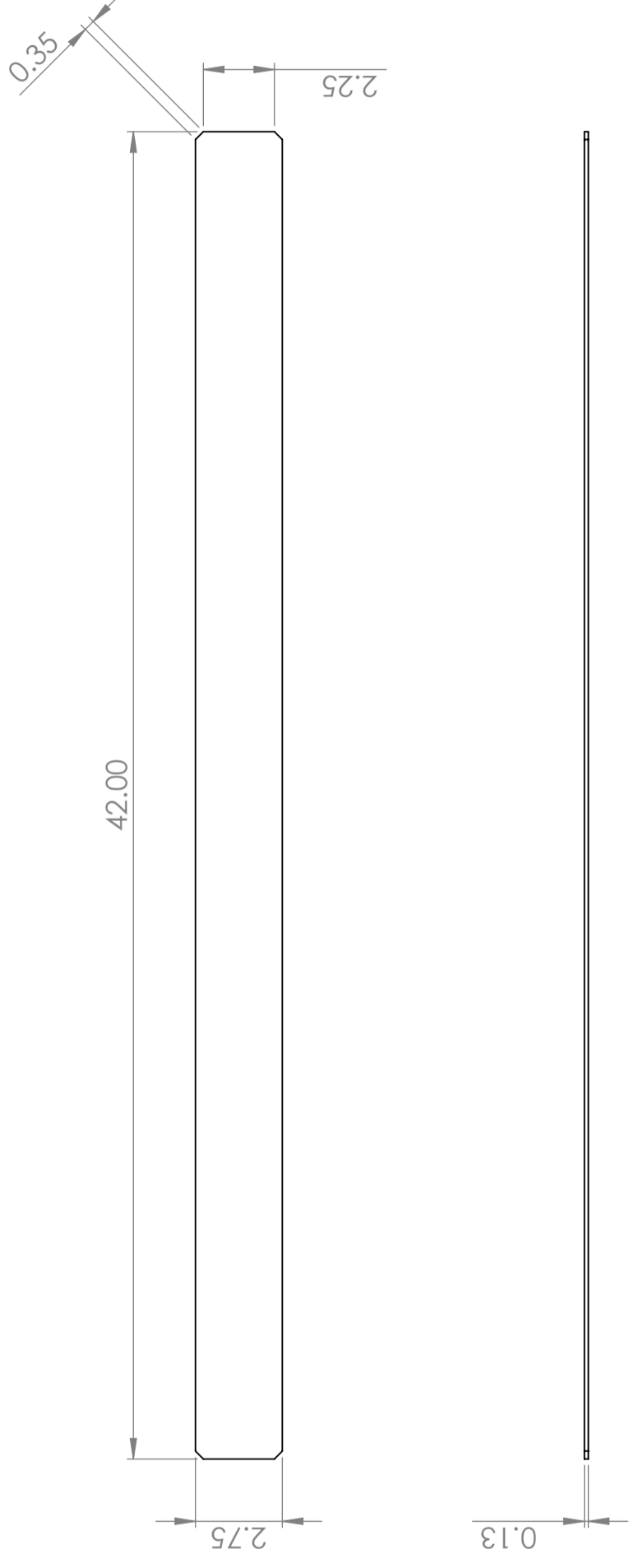

UNLESS OTHERWISE SPECIFIED: DIMENSIONS ARE IN INCHES		FINISH:		DEBUR AND BREAK SHARP EDGES		DO NOT SCALE DRAWING		REVISION	
SURFACE FINISH:									
TOLERANCES:									
LINEAR:									
ANGULAR:									
	NAME	SIGNATURE	DATE	TITLE:					
DRAWN									
CHK'D									
APP'VD									
MFG									
Q.A.									
				MATERIAL:		DWG NO.		A3	
						Rev2_Belt_Padding			
				WEIGHT:		SCALE: 1:5		SHEET 1 OF 1	

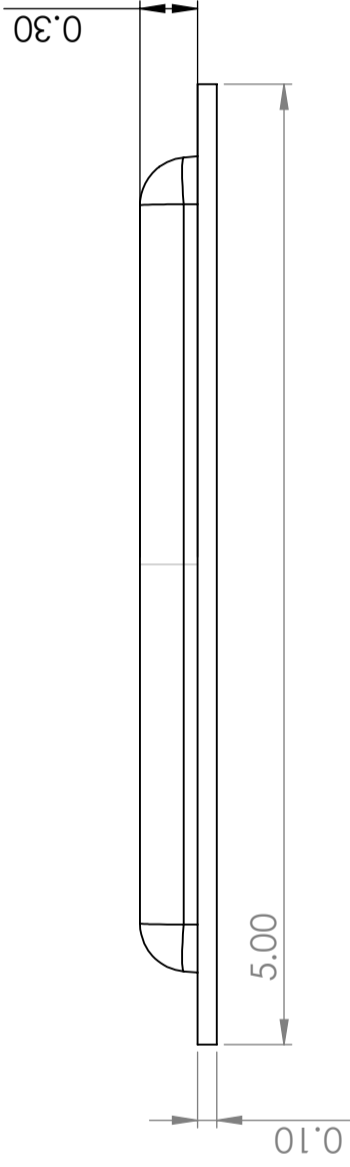
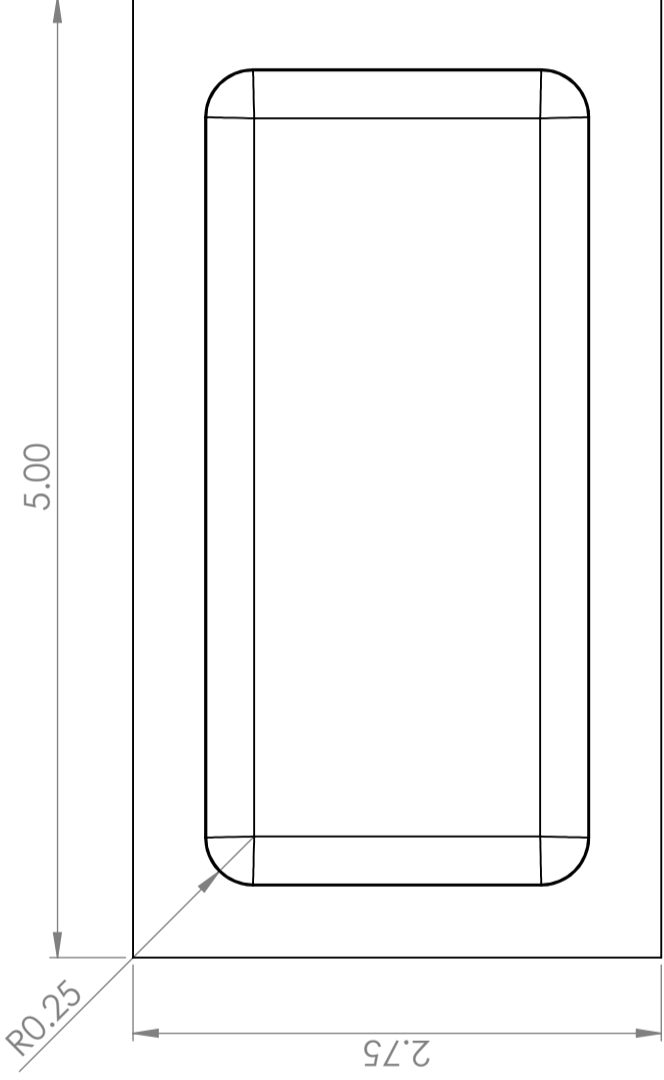

UNLESS OTHERWISE SPECIFIED: DIMENSIONS ARE IN INCHES		FINISH:		DEBUR AND BREAK SHARP EDGES		DO NOT SCALE DRAWING		REVISION	
SURFACE FINISH:									
TOLERANCES:									
LINEAR:									
ANGULAR:									
DRAWN	NAME	SIGNATURE	DATE	TITLE:					
CHK'D									
APP'VD									
MFG									
Q.A.									
				MATERIAL:		DWG NO.		A3	
						Rev2_Belt_Hip_Pad		SCALE: 1:1	
				WEIGHT:		SHEET 1 OF 1			

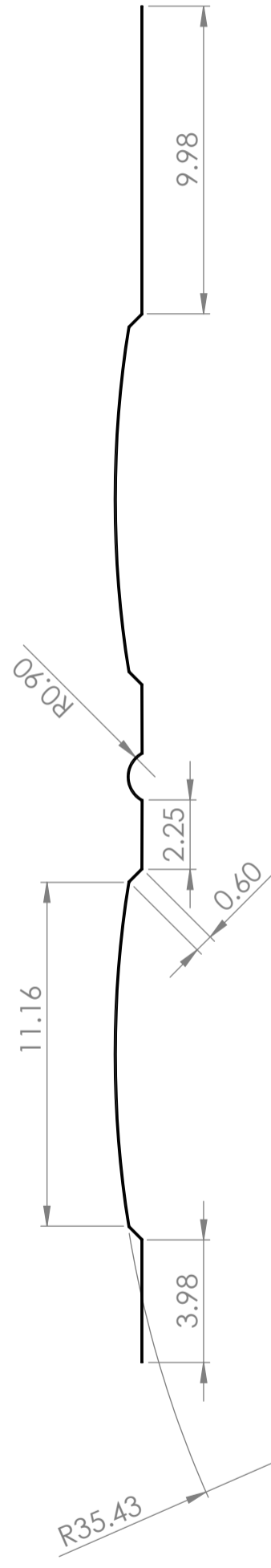

UNLESS OTHERWISE SPECIFIED: DIMENSIONS ARE IN INCHES		FINISH:		DEBUR AND BREAK SHARP EDGES		DO NOT SCALE DRAWING		REVISION	
SURFACE FINISH:									
TOLERANCES:									
LINEAR:									
ANGULAR:									
NAME	SIGNATURE	DATE	TITLE:						
DRAWN									
CHK'D									
APP'VD									
MFG									
Q.A.									
			MATERIAL:		DWG NO: Rev2_Belt_Strap A3				
			WEIGHT:		SCALE: 1:5 SHEET 1 OF 1				